

PORTFOLIO

ARCHITECTURAL DESIGN FOR K-12





40+

YEARS OF OFFERING INNOVATIVE & COMPREHENSIVE DESIGN SOLUTIONS

Founded in 1978, Design Collective is a multidisciplinary design firm offering expertise, leadership and innovation in sustainable campus planning, architecture, interiors, landscape architecture, environmental signage and graphics.

The firm has over 35 years of experience designing academic and student life buildings for primary and secondary schools, as well as major college and universities throughout the United States, successfully completing over 350 educational projects totaling well over \$2 billion on more than 55 primary, secondary and post-secondary campuses across the country. Our team is in tune with current trends and the future of 21st Century teaching and learning. As PKAL strategies continue to evolve, we leverage our in-house expertise to create flexible, state-of-the-art environments that enhance and promote learning.

OFFICE LOCATIONS

Baltimore
100 East Pratt Street, 18th Floor
Baltimore, Maryland 21202
☎ 410.685.6655

Chicago

233 South Wacker Drive, Suite 4400
Chicago, Ill 60606
☎ 312.625.4747

WEBSITE

www.designcollective.com

SERVICES

- Architecture
- Interiors
- Urban Design & Planning
- Landscape Architecture
- Environmental Signage & Graphics

CORE COMPETENCIES

- Education Facilities
- Student Housing & Student Life Facilities
- Mixed-Use Multi-Family
- Urban Design & Infill Development
- Life Sciences & Research Facilities
- Commercial Office & Workplace Environments



80+
EMPLOYEES



100%
EMPLOYEE OWNED



50+
LEED CERTIFIED
PROJECTS



25+
SCHOOLS IN
MARYLAND



350+
DESIGN AWARDS



REGISTERED IN
30+ STATES



5+
NEW ELEMENTARY/
MIDDLE SCHOOLS



COMMITMENT TO EDUCATION

Design Collective has successfully collaborated with many distinguished educational clients on over 25 master planning, new construction, renovation and in-fill projects with a combined construction cost over \$190 Million. Our success in designing educational facilities stems from our commitment to understanding education and evolving pedagogies. Your school design projects will benefit from our dedication to learning more about your teachers' and students' needs. We are active participants in the Association for Learning Environments (A4LE) and the Association of School Business Officials (ASBO) locally and regionally.

DESIGN LEADERS IN EDUCATIONAL SPACES



PIMLICO ELEMENTARY / MIDDLE SCHOOL

HISTORIC MODERNIZATION

PIMLICO ELEMENTARY / MIDDLE SCHOOL

BALTIMORE CITY PUBLIC SCHOOLS
BALTIMORE, MD



COST
\$31.5 Million

SQUARE FEET
155,034 SF

PROJECT SUMMARY
Pimlico Elementary/Middle School includes the full renovation and modernization of 78,000sf of existing building as well as a 40,000sf addition. The original 1910 school building was rebuilt to support the elementary component of the project while the 1924 building now houses the middle school. The goal of this project was to maintain the existing historic buildings to the extent feasible while using new additions to unify the site and create a 21st century learning environment for the students at Pimlico ES/MS. The previous 1924 gymnasium, while not large enough to support middle school athletics, was repurposed into a high-volume media center with open ceilings and high windows. The former activities core was renovated to provide a modernized dining room with natural lighting and an expanded kitchen to meet the needs of the school. New community space and a gymnasium were added to this wing of the building to serve the school as well as the surrounding community.

- SCOPE**
- Historic Facade Renovation & Addition
 - Secure Entry Vestibule
 - New Lobby & Offices
 - Physical Sciences Lab
 - Community Space & Gymnasium
 - Media Center
 - Dining Room & Kitchen
 - Playground & Outdoor Learning Spaces





ARLINGTON ELEMENTARY SCHOOL

ARLINGTON ELEMENTARY SCHOOL

INNOVATIVE ADDITION

ARLINGTON ELEMENTARY

BALTIMORE CITY PUBLIC SCHOOLS
BALTIMORE, MARYLAND



COST

\$37.3 Million

SQUARE FEET

102,000 SF

SCOPE

- Pre-k Classrooms
- Kindergarten Classrooms
- Three Classrooms per Grade (grades 1-5)
- Judy Center and Headstart program
- Weinberg Early Childhood Development Center
- Special Education Room
- Science Room
- Art Room
- Computer Lab
- Community Space
- Administrative/Support Space

PROJECT SUMMARY

Arlington Elementary School includes a full renovation and modernization of the existing 1925 and 1936 buildings as well as an 18,000sf addition which includes a Head Start program and an early childhood development center. The existing lower level cafeteria and classrooms were expanded to provide additional square footage as well as a terrace that is used for dining and outdoor classroom space. The existing historic buildings facades were repaired to maintain their historic character and integrity. The landscape and play areas support the goals of 21st century learning and reinforce the idea that teaching and learning can occur beyond the walls of the classroom. The new Arlington Elementary School is flexible and adaptive, inspires social interaction, and supports diverse learning and teaching styles. The school building is on the cutting edge of technology and environmental sustainability and became the hub of the community it serves. The Early Childhood Development Center (ECDC) functions independently from the school with its own dedicated drop off, parking and entrance. The center is a series of classroom, support, and administrative spaces and is designed to meet Maryland state guidelines for child care centers. The renovated building opened for the 2019-2020 school year and has achieved LEED Gold certification.





FRANCIS SCOTT KEY ELEMENTARY & MIDDLE

RENOVATION & REINVENTION

FRANCIS SCOTT KEY ELEMENTARY & MIDDLE

BALTIMORE CITY PUBLIC SCHOOLS

BALTIMORE, MD

COST

\$1.9 Million

SQUARE FEET

3,000 SF

SCOPE

- Lobby Renovations
- Public Corridor Configuration
- Renovate Physical Sciences Lab
- Teacher Prep Room
- Lego Robotics Lab
- Middle School Physical Sciences Lab

PROJECT SUMMARY

The Baltimore City Public School System engaged Design Collective to develop a program and conceptual design package for renovations to Francis Scott Key Elementary and Middle School. The goal was to begin to reposition the school and reinvent the middle school to support a STEM focus. Phase I included renovations to the lobby, public corridors and the renovation of 3,000 SF to house a physical science lab and VEX robotics test track. Phase II included the renovation of the physical sciences lab, storage room into a teacher prep room for group work, renovation of the computer classroom for Lego Robotics lab, and renovation of the current home economics room into the middle school physical sciences lab.

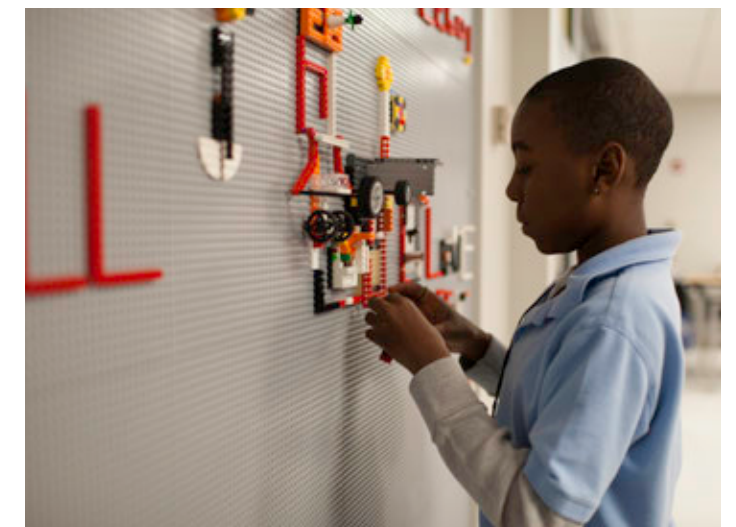
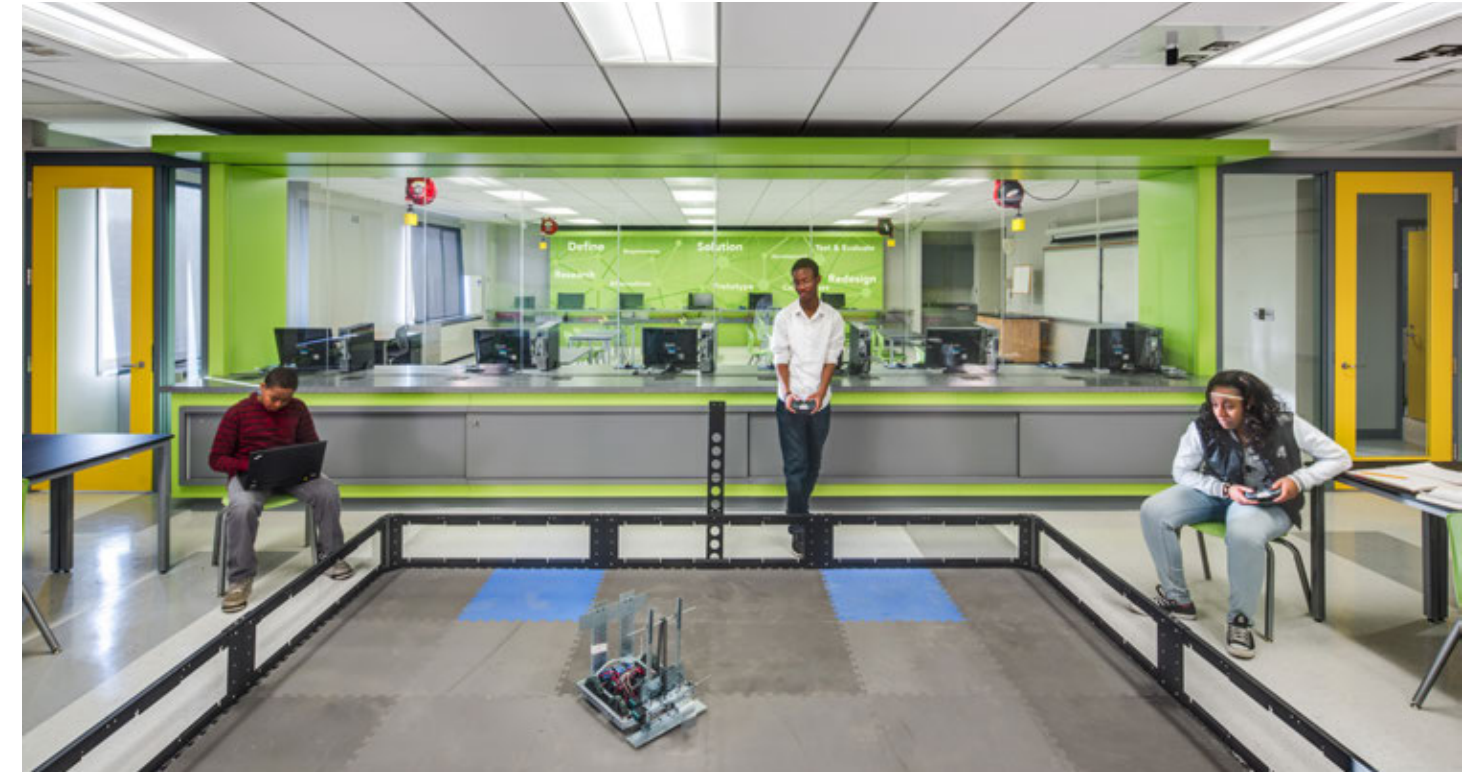



COLGATE ELEMENTARY

A NEW FRONT DOOR

COLGATE ELEMENTARY

BALTIMORE COUNTY PUBLIC SCHOOLS
DUNDALK, MARYLAND



COST

\$34.6 Million

SQUARE FEET

88,000 SF

SCOPE

- Pre-k Classroom
- Kindergarten Classrooms
- Collaboration Spaces
- Green Roof
- Historic Elements
- Media Center
- Security Vestibule

PROJECT SUMMARY

Design Collective was selected by Baltimore County Public Schools to provide design and construction administration services for the replacement of the existing Colgate Elementary School originally built in 1924, with subsequent additions over the decades, in Dundalk, Maryland.

Anchoring the corner of 51st and Gough street, the new Pre-K-5 school is approximately 88,000 square feet on a 5 acre site. Based on the flexible West Towson Elementary prototype, the design easily accommodated additional classrooms and collaboration areas that were program specific to this project with an expected capacity of 530 students. Shared community spaces are integrated for after hours use with the gym, cafeteria, and large meeting rooms, as well as access to restroom facilities when the exterior recreational fields are in use. The occupiable green roof overlooking the neighborhood can be used as a teaching area, directly accessible from the art and maker space classrooms on the upper floor. Lastly, the materials and design motif for the exterior of the building respect the language of the neighborhood while harkening back to turn of the century industrial Baltimore.

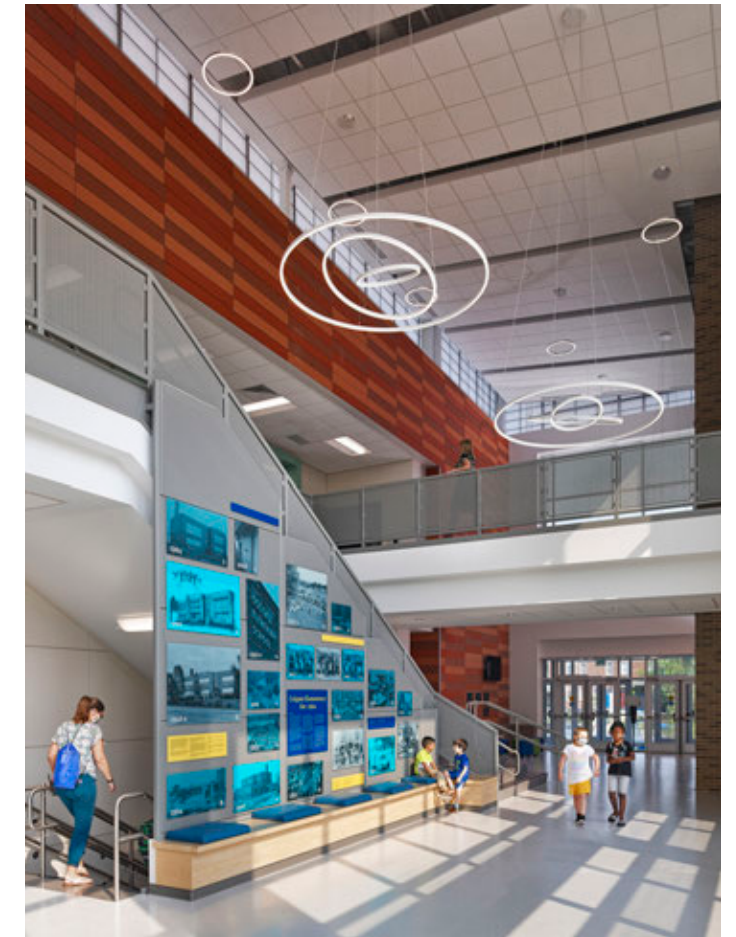



MEDFIELD HEIGHTS ELEMENTARY SCHOOL

MEDFIELD HEIGHTS ELEMENTARY

CONTINUITY & TRANSFORMATION

MEDFIELD HEIGHTS ELEMENTARY

BALTIMORE CITY PUBLIC SCHOOLS
BALTIMORE, MARYLAND



COST

\$32.3 Million

SQUARE FEET

79,000 SF

SCOPE

- Pre-k Classrooms
- Kindergarten Classrooms
- Collaboration Spaces
- Three Stories
- Playground
- Cafeteria
- Auditorium
- Science Room

PROJECT SUMMARY

Medfield Heights Elementary School was constructed in 1955 and a modular building was located behind the main school building in 1970. The previous building was three stories and a total of 41,932 square feet. The replacement school had a state rated capacity of 491 elementary school students, grades pre-kindergarten through fifth grade. To bring a 21st century learning environment to the community, the existing building was demolished and the new Medfield Heights Elementary School was new construction. The new facility is a 3 Section School comprised of three stories and approximately 71,000 total square feet. Design Collective's design includes a classroom wing oriented east-west along Wood Heights Avenue. The building is set back from the roadway to allow for a PreK/K Play area to be located in front of the building, accessible and visible to the surrounding community.





WEST TOWSON ELEMENTARY

SUSTAINABILITY & DESIGN

WEST TOWSON ELEMENTARY

BALTIMORE COUNTY PUBLIC SCHOOLS
TOWSON, MARYLAND



COST

\$16.2 Million

SQUARE FEET

69,300 SF

SCOPE

- Pre-k Classroom
- Kindergarten Classrooms
- Three Classrooms per Grade
- Special Education Room
- Science Room
- Art Room
- Computer Lab
- Combined Gym/Cafeteria
- Administrative/Support Space

PROJECT SUMMARY

This 69,300 square foot three story building accommodates 451 students and is the first USGBC LEED Silver Certified public school in Baltimore County. The new learning center includes one Pre-K classroom, three kindergarten classrooms, three classrooms for each grade – 1 through 5 – a special education room, science room, art room, computer lab, combined gymnasium/cafeteria, and administrative and support spaces. Within the center, technology has seamlessly integrated with traditional learning tools to create a learning environment for the modern age. Additional spaces within the library have been created to accommodate a variety of learning environments and methods. The school also features a state-of-the-art media center and television studio. An accessible demonstration green roof doubles as an outdoor classroom for active learning. Located on the second floor, between the art and the science departments, along a major interior corridor, the green roof was designed to provide teachers with outdoor space for interactive learning to nurture the scientific and creative aspects of the young developing mind.





VIERS MILL ELEMENTARY SCHOOL

DESIGNING FOR SECURITY

VIERS MILL ELEMENTARY SCHOOL

MONTGOMERY COUNTY PUBLIC SCHOOLS
SILVER SPRING, MARYLAND

COST
\$898,000

SQUARE FEET
1,300 SF

SCOPE

- Security Vestibule
- Renovation

PROJECT SUMMARY

The Viers Mill Elementary School required the addition of a secure main entry vestibule. Unfortunately, the main offices for the school were located on the opposite side of the corridor from the existing front doors. Design Collective proposed a creative solution to expand the scope of the project to relocate the offices into a new addition adjacent to the front doors. This allowed visitors entering the secure vestibule to directly enter to new office to be appropriately checked in for entry. The original offices were redesigned for use as other program elements to supplement the school's student support services.

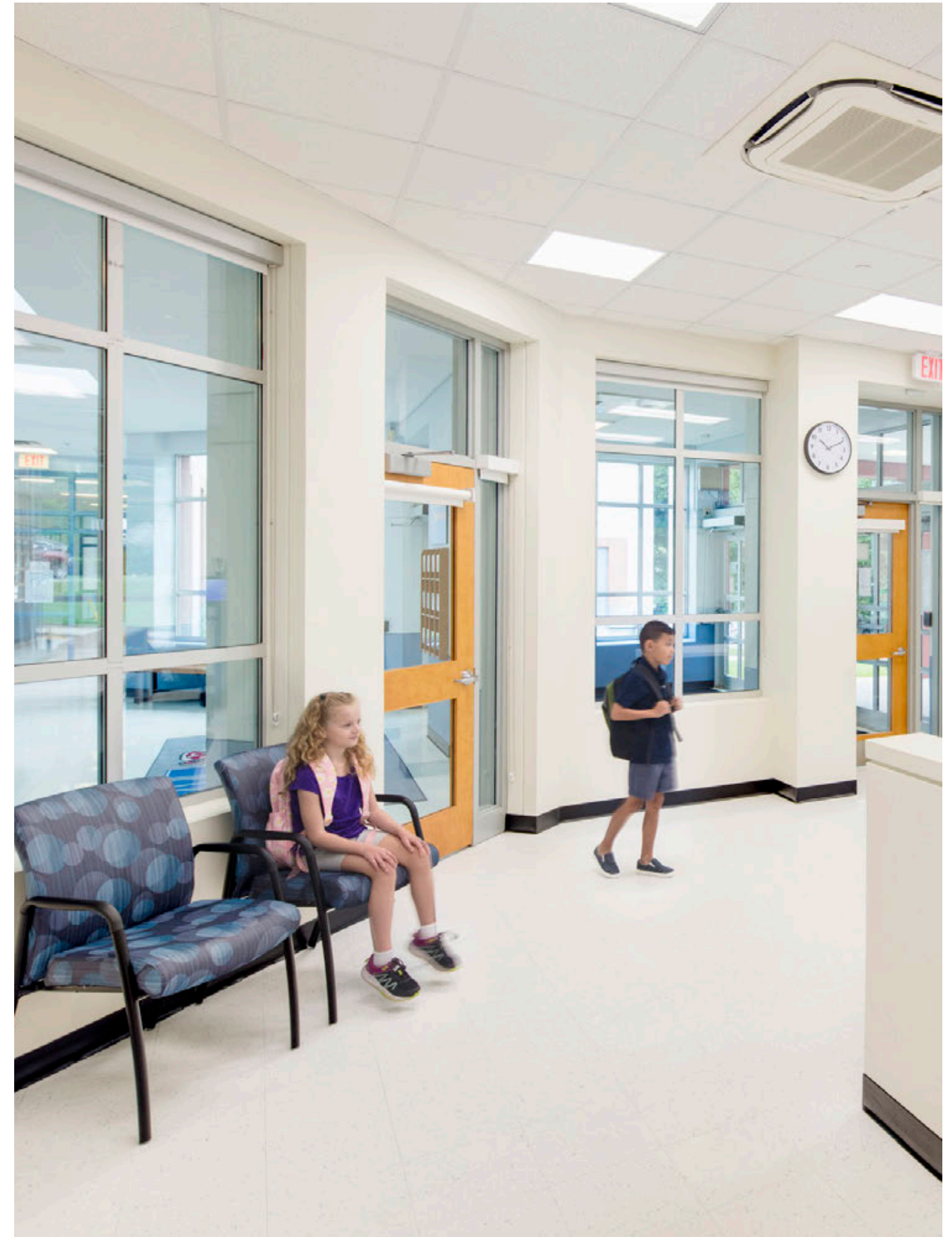

ERINN MCCARTHY HUMANITIES HALL

MARYVALE PREPARATORY SCHOOL
BROOKLANDVILLE, MARYLAND

COST

\$11.4 Million

SQUARE FEET

30,000 SF

SCOPE

- New Humanities Building
- New Athletic Fields
- Additional Parking
- Improved Pedestrian/Vehicular Pathways
- New Campus-wide Stormwater System

PROJECT SUMMARY

Maryvale Preparatory School, a private girls school for grades 6-12, retained Design Collective in 2004 to provide a campus master plan. Design Collective was recently hired to provide design services for a new Humanities Building. The campus expansion plans include the new Humanities Building, new athletic fields, additional parking, improved pedestrian/vehicular pathways and a new campus-wide stormwater system.

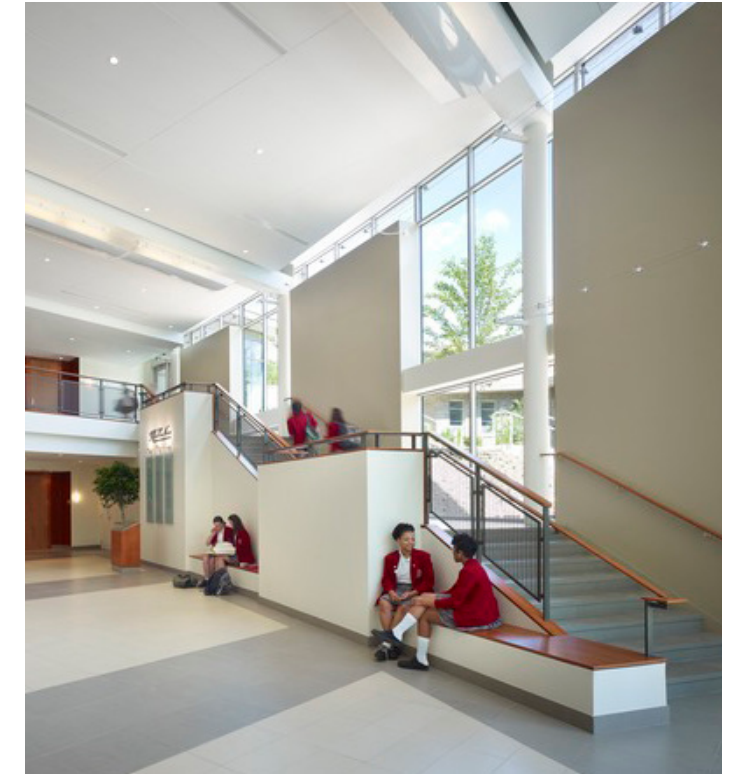



MULTIPLE SCHOOLS

FEASIBILITY STUDIES

LYNDHURST ELEMENTARY & MIDDLE

BALTIMORE CITY PUBLIC SCHOOLS

BALTIMORE, MARYLAND

BRIEF DESCRIPTION

Design Collective was tasked with a feasibility study and program development for a 2 section Pre K - 8 school located in West Baltimore. The plan calls for combining two schools, Rognel Heights Elementary and Middle School and Lyndhurst Elementary School, creating one fully renovated school on the site of the current Lyndhurst Elementary School. The study had a major public participation effort to ensure the community, teachers, administration, students and parents were involved in this important study. The public engagement process included several workshops with hands-on activities.



CROMWELL VALLEY ELEMENTARY

BALTIMORE COUNTY PUBLIC SCHOOLS

TOWSON, MARYLAND

PROJECT SUMMARY

Design Collective was tasked with design of additions and renovations to the existing school. The expanded school was designed to accommodate 620 students and approximately 30-40 faculty and staff. The project was to include a full renovation of the existing 57,344 sf building, and a series of additions, totaling approximately 33,436 sf, for a completed building area of 90,780 sf. A series of four primary building additions were designed, including an addition to the Administrative Offices, in connection with a new, larger vestibule and more secure/visible entry.



FEASIBILITY STUDIES

BALTIMORE CITY PUBLIC SCHOOLS
BALTIMORE, MARYLAND

PROJECT SUMMARY

Design Collective in collaboration with Samaha Associates was selected by Baltimore City Public Schools to prepare feasibility studies for three (3) schools: **Cross Country Elementary/Middle School**, **Calvin M. Rodwell Elementary and Middle School**, and **John Ruhrah Elementary/Middle School**. The studies review existing building infrastructure, compliance with existing codes, and the condition of building structural, mechanical, electrical and plumbing systems. The design team evaluates the existing educational spaces to see if they are serving the programmatic needs of the students. Three options for the school are evaluated; strategic renovation, a complete renovation and replacement in which a new school would be constructed on the existing site.

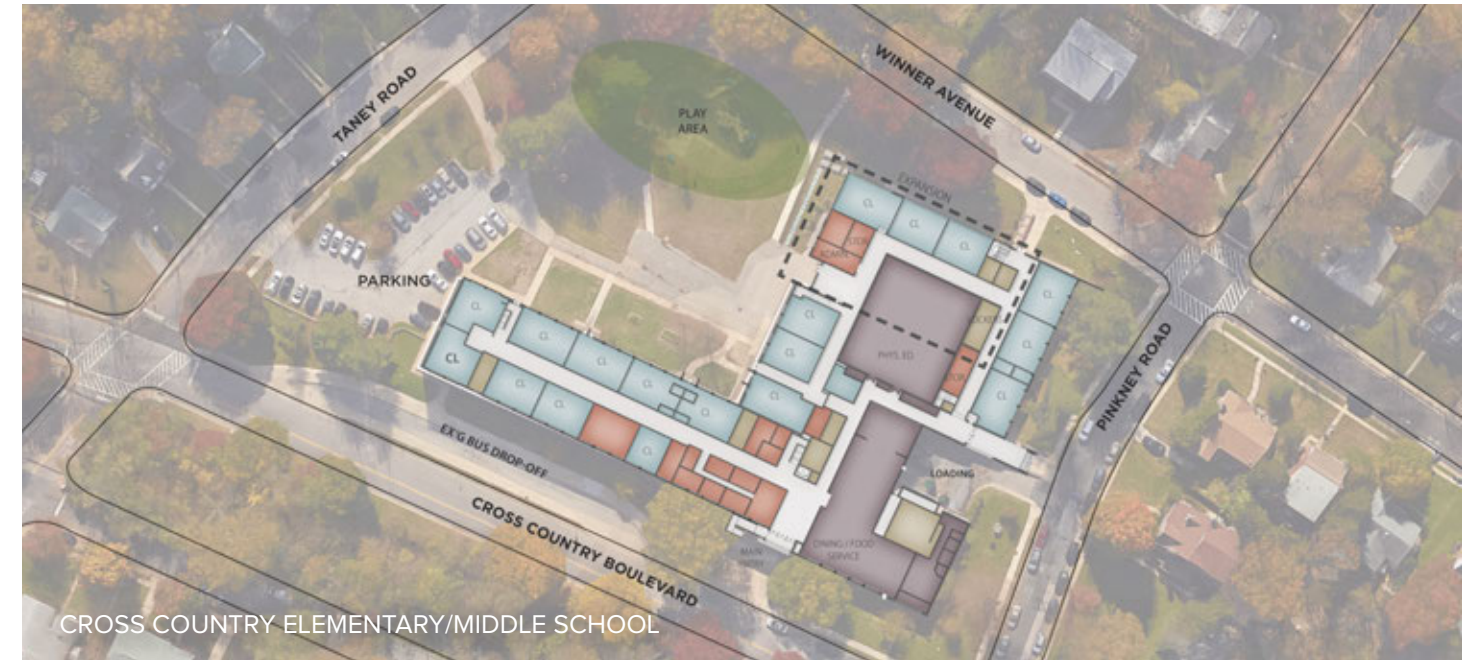



MULTIPLE SCHOOLS

ON OUR SCREENS

WOODLIN ELEMENTARY SCHOOL

MONTGOMERY COUNTY PUBLIC SCHOOLS

SILVER SPRING, MARYLAND

PROJECT SUMMARY

Design Collective was selected by Montgomery County Schools to provide design and construction services for the replacement of Woodlin Elementary School. The existing school will be replaced with a new 21st century school for grades PreK-5th and be approximately 90,000 SF. The new design includes a compact, efficient floor plan which takes advantage of the site topology and allows adequate outdoor play and learning spaces. A new bus loop will be provided at the school to alleviate traffic in the residential neighborhood in which the school is located. An expanded parking lot and drop off area will serve both the school and the country owned daycare center which shares the site. Design was completed in 2021 and the project is currently under construction. Students are expected to occupy the new building in December 2023.





WOODLIN ELEMENTARY SCHOOL

ARMISTEAD GARDENS

BALTIMORE CITY PUBLIC SCHOOLS
BALTIMORE, MARYLAND

PROJECT SUMMARY

Armistead Gardens PK-8 School #243 was originally constructed in 1951 as a 63,105 gsf single-story building located on the west side of the existing site. A small addition of 6,580 gsf was constructed in 1959. In 1991, the entire building, except for the gymnasium and attached Parks & Recreation community center, was demolished and replaced with a 50,498 gsf addition to the east side of the site. The current school is a partially two-story building totaling 62,031 gsf, excluding the attached, but separately owned community center. Limited and systemic renovations of various components of the building have been completed since 2002, but no major additions or comprehensive renovations have occurred.

In addition to its physical constraints and deteriorating condition, the building at Armistead Gardens no longer meets the educational needs of the community or Baltimore City Schools. It has an SRC of 373 and an FTE of 780 (as of 2020). Two modular classroom buildings were added to the site in 2008, totaling 22,500 gsf and providing 20 additional classrooms, to supplement the undersized building.

To better provide a 21st Century learning environment, an addition of 91,820 gsf will be constructed to the west side of the existing building, bringing the total area to 148,590 gsf. The addition and renovation of the existing building will be performed in a phased-occupied scenario, using new temporary modular classrooms to house students at various phases. The proposed addition will be partially two-stories, with the First Floor located twenty-eight inches above the level of the existing building's main floor, due to the site's topography. A series of interior ramps and an open courtyard will mitigate this elevation change within the building's First Floor and the new Second Floor will be accessed by stairs and an additional elevator.



McDONOGH SCHOOL

THE McDONOGH SCHOOL
OWINGS MILLS, MARYLAND

PROJECT SUMMARY

McDonogh School recently selected Design Collective for the renovation of its historic Allan Building; the School's signature academic facility with an iconic clock tower symbolic of the school. Built in 1929, the 80,000 square foot Allan Building currently houses the Upper School Science, Math and History classrooms and key administrative offices. The building will undergo a comprehensive renovation to transform the "back" of the Allan Building and Burke Center into a functional front; upgrade building systems; improve space efficiency; and reinforce the campus master plan to ensure the continuity of the history, legacy and tradition of McDonogh.

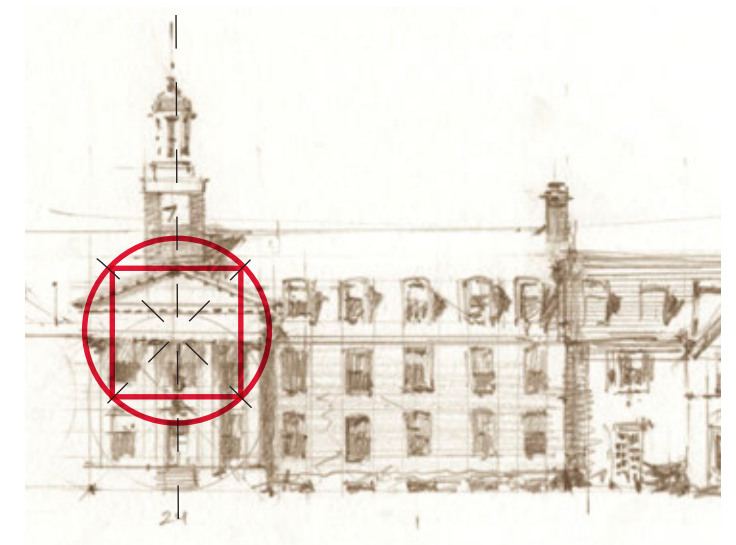
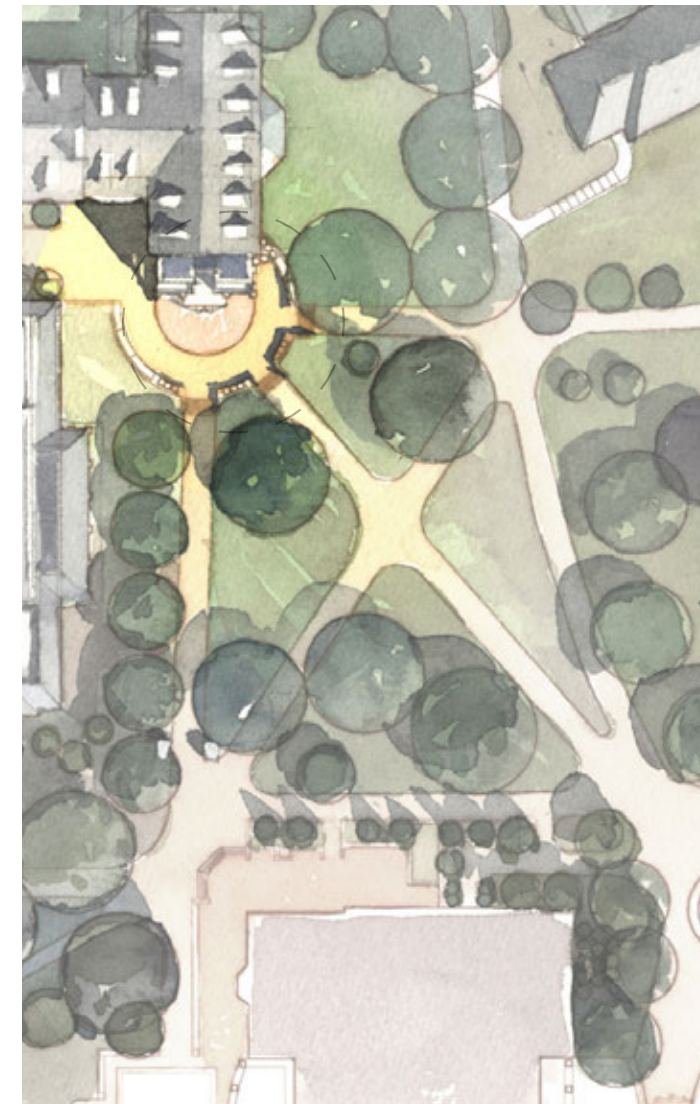

DULANEY HIGH SCHOOL

BALTIMORE COUNTY PUBLIC SCHOOLS
TIMONIUM, MARYLAND

PROJECT SUMMARY

Design Collective, in collaboration with Samaha Associates, was recently selected by Baltimore County Public Schools to design select renovations for Dulaney High School in Timonium, Md. The renovation is expected to include the replacement of all mechanical systems and windows, the installation of a new roof, and improvements to the health suite, library/media center, main office and guidance facilities. The project Construction Documents were completed and bid in February 2017, with all four bids below the construction estimate. However, the Board of Education deferred award of the contract indefinitely.



EAGLE ACADEMY PUBLIC CHARTER SCHOOL DESIGN-BUILD PROJECT

EAGLE ACADEMY
WASHINGTON, DC



PROJECT SUMMARY

This project consists of providing A/E services as a design-build with Costello Construction for the design and construction of a new PreK-2nd grade school building for Eagle Academy. The building will be approximately 20,000 SF, have 12 classrooms, a multipurpose room, a reheat kitchen, administrative offices, a health suite, an elevator and support spaces as required. The design team will designate site location for two separate play areas and a parking lot with a maximum of 20 spaces will be provided on site. The building will achieve LEED Gold under version 2009.



VICTORY VILLA ELEMENTARY

BALTIMORE COUNTY PUBLIC SCHOOLS

MIDDLE RIVER, MARYLAND

PROJECT SUMMARY

The original Victory Villa Elementary School (VVES) was built in 1943 and sits on a 12.45-acre site. Design Collective was commissioned to identify possible options for the capital improvements to VVES, including the complete replacement option versus a renovation and addition option. The Study Team developed three possible design options that met the intent of the Ed Spec and address the existing building and site conditions.



K-12 CLIENT LIST

PUBLIC SCHOOLS

BALTIMORE COUNTY PUBLIC SCHOOLS

- Colgate Elementary
 - » Replacement School
- Cromwell Valley Elementary
 - » Renovation & Additions
- Deer Park Elementary School
 - » Feasibility Study
- Dulaney High School
 - » Site Study
 - » HVAC Improvements
- Holabird STEM Academy
 - » Limited Renovation
- Kenwood High School
 - » HVAC Replacement
- Norwood Elementary
 - » Limited Renovation
- Victory Villa Elementary
 - » Feasibility Study
- West Towson Elementary
 - » Feasibility Study
 - » Replacement School

BALTIMORE CITY PUBLIC SCHOOL SYSTEM

- Arlington Elementary
 - » Renovation & Addition
- Armistead Gardens Pre-K to 8
 - » Addition & Renovation
- Calvin M. Rodwell Elementary
 - » Feasibility Study
 - » Replacement School
- Cross Country Elementary
 - » Feasibility Study
- Fallstaff Elementary
 - » Roof Replacement
 - » Window Replacement
- Francis Scott Key Elementary & Middle
 - » Renovation
- James Mosher Elementary & Middle
 - » Feasibility Study
- John Ruhrah Elementary & Middle
 - » Feasibility Study
- Lyndhurst Elementary & Middle
 - » Feasibility Study
 - » Program Development
- Medfield Heights Elementary
 - » Replacement School
- Pimlico Elementary & Middle
 - » Renovation & Additions

MONTGOMERY COUNTY PUBLIC SCHOOLS

- New Woodlin Elementary School
 - » Replacement School
- Viers Mill Elementary School
 - » Security Vestibule

FREDERICK COUNTY PUBLIC SCHOOLS

- Monocacy Elementary School
 - » Feasibility Assessment
 - » Architectural/Engineering Consultant Services

PRINCE GEORGE'S COUNTY PUBLIC SCHOOLS

- Berwyn Elementary School
 - » Renovation

DURHAM COUNTY PUBLIC SCHOOLS (NORTH CAROLINA)

- E.K Powe Elementary
 - » Renovation

IDIQ & TASK ORDER CONTRACTS

- Baltimore City Public Schools
- Baltimore County Public Schools
- Howard County Public Schools
- Prince George's County Public Schools

INDEPENDENT SCHOOLS

SHOSHANA S. CARDIN JEWISH COMMUNITY HIGH SCHOOL

- » Campus Master Plan
- » Conceptual Design

MARYVALE PREPARATORY SCHOOL

- » Campus Master Plan
- » Humanities Building

MCDONOGH SCHOOL

- Allan Building Renovation
 - » Library Expansion

Lyle Building Renovation

- » Administration Building & School

Burck Center Addition and Renovation

- » Arts & Music Programs

Naylor Math and Science Building

- » Furniture Selection

Edward St. John Student Center Building

- » Wayfinding, ADA, Donor & Faculty Recognition Signage
- » Furniture Selection

EAGLE ACADEMY PUBLIC CHARTER SCHOOL

- » New PK-2 School



Design Collective

ARCHITECTURE
PLANNING
INTERIORS
LANDSCAPE ARCHITECTURE
GRAPHICS

Baltimore

100 East Pratt Street, 18th Floor
Baltimore, Maryland, 21202
P 410.685.6655

Chicago

233 South Wacker Drive
Chicago, Ill 60606
P 312.625.4747

www.designcollective.com

100% Employee-Owned Design Firm